

# Field House Drawings

NO. 1	NO. 2	NO. 3	NO. 4	NO. 5	NO. 6	NO. 7	NO. 8	NO. 9	NO. 10
NO. 11	NO. 12	NO. 13	NO. 14	NO. 15	NO. 16	NO. 17	NO. 18	NO. 19	NO. 20
NO. 21	NO. 22	NO. 23	NO. 24	NO. 25	NO. 26	NO. 27	NO. 28	NO. 29	NO. 30

PROPOSED INDOOR SOCCER FIELD  
 OAKS ROAD  
 BRECKSVILLE, OHIO  
 CITY OF BRECKSVILLE  
 PROPOSED FIRST FLOOR PLAN

DONALD W. GROSSENBAUGH ARCHITECT  
 P.O. BOX 470250  
 BROADVIEW HEIGHTS, OHIO  
 PH: 440/838-8220  
 FAX: 440/838-8221

**A2**

DATE: MAY 4, 2011  
 SCALE: AS SHOWN  
 SHEET NO. 1101

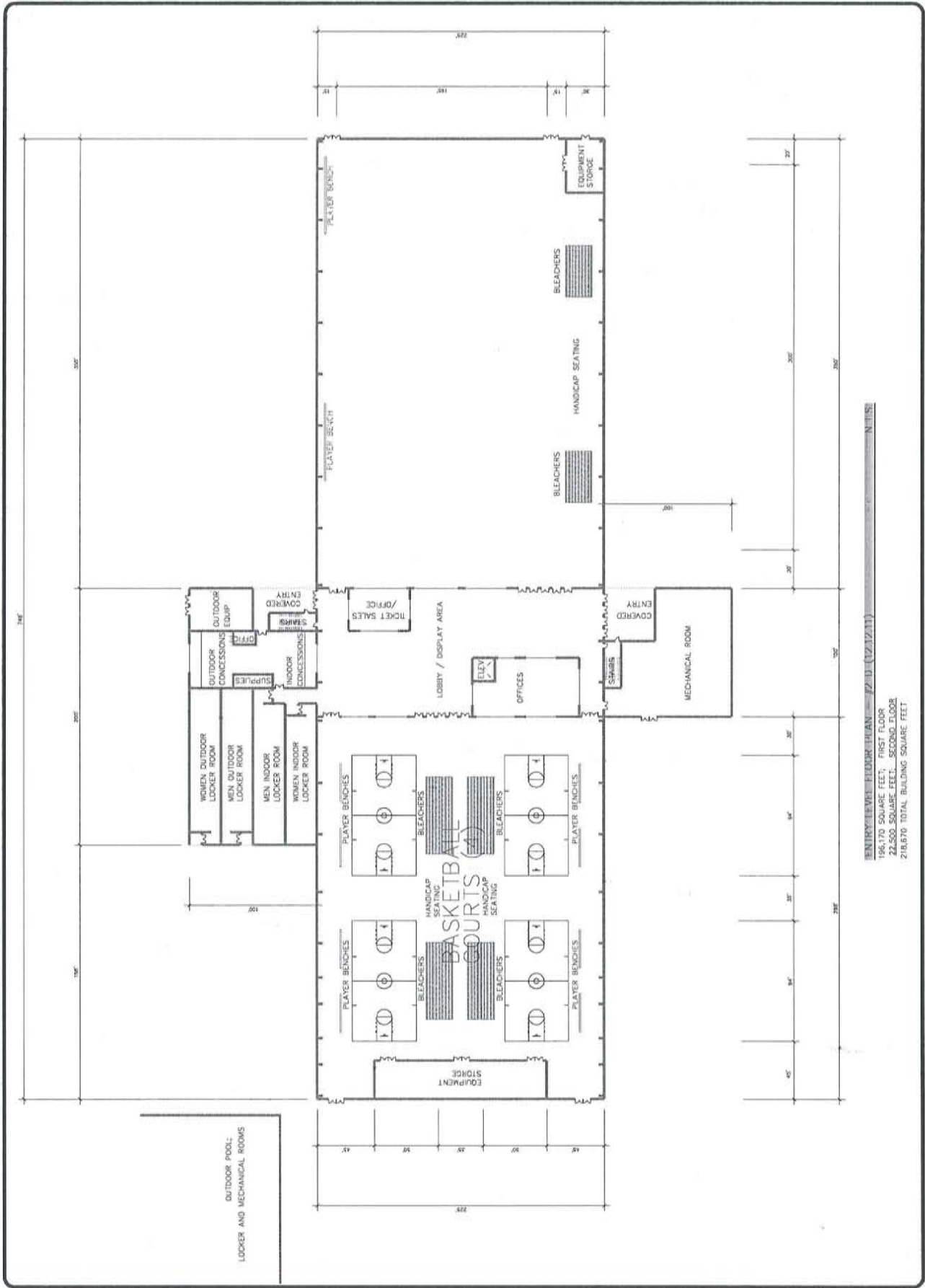

ENTRY LEVEL - FLOOR PLAN (1/2" = 1'-0")  
 196,170 SQUARE FEET, FIRST FLOOR  
 22,500 SQUARE FEET, SECOND FLOOR  
 218,670 TOTAL BUILDING SQUARE FEET



DATE	
BY	
NO.	
REV.	
DATE	
BY	
NO.	
REV.	
DATE	
BY	
NO.	
REV.	

PROPOSED INDOOR SOCCER FIELD  
 CITY OF BRECKSVILLE  
 OAKS ROAD  
 BRECKSVILLE, OHIO  
 PROPOSED SECOND FLOOR PLAN

DONALD W. GROSSENBAUGH ARCHITECT  
 P.O. BOX 470250  
 BROADVIEW HEIGHTS, OHIO  
 PH: 440/838-8220  
 FAX: 440/838-8221

REVISIONS									
NO.	DATE	DESCRIPTION	BY	CHKD	APP'D	DATE	NO.	DATE	DESCRIPTION
1									
2									
3									
4									
5									
6									
7									
8									
9									
10									

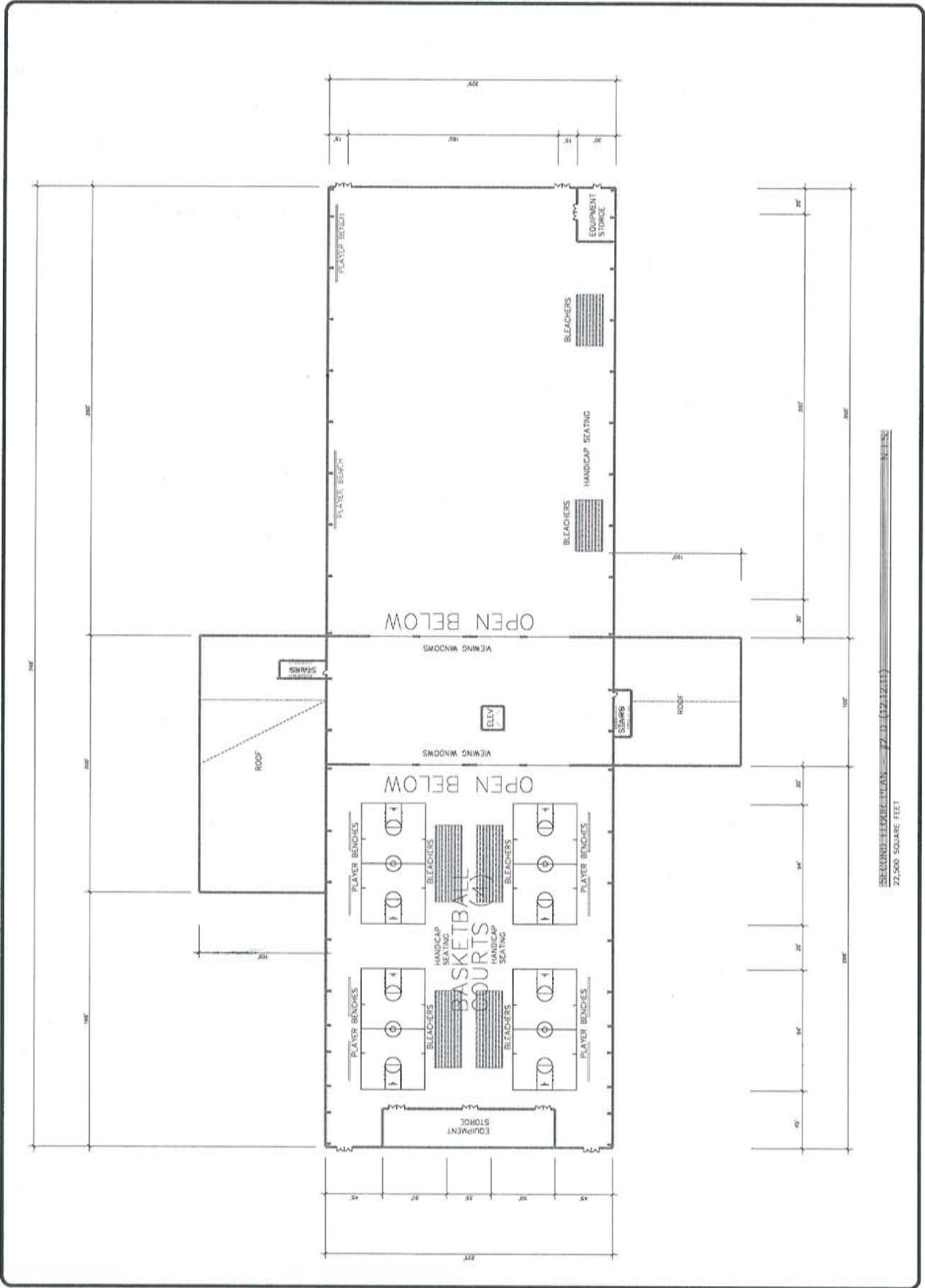

SECTION 111000 - FLOORING  
 22,500 SQUARE FEET

NO.	DESCRIPTION	DATE

PROPOSED INDOOR SOCCER FIELD  
 CITY OF BRECKSVILLE  
 OAKS ROAD  
 BRECKSVILLE, OHIO  
 PROPOSED FIRST FLOOR PLAN

DATE	JULY 14, 2011
DRAWN BY	[Signature]
CHECKED BY	[Signature]
SCALE	AS SHOWN
PROJECT NO.	11001
SHEET	A2

